

Name:

Indicate 1st, 2nd and 3rd preference

King's Court Garden - Community Task Sign-up Form - 2022

Late Season version	# of slots	Early Season	# of slots	Late Season	# of slots	All Season	Winter
Common Areas	available		available		available		
Pathway							
Area 2	1		1				
Area 2a	1		1				
Area 3	1		1				
Area 4	1		1				
Area 4a	1		1				
Area 5	1		1				
Area 6	1		1				
Area 7	1						
Area 8	1		1				
Area 8A	1		1				
East end mtg. space - Area 1	2		2				
Shed side and back - Area 1A	1		1				
BBQ space - Area 1B	1		1				
Shed interior - Area 1C	1		1				
Exterior Areas							
Area 10 East gate grdn					1		
Area 15 Pollinator Garden, east							
Area 9 Pollinator Garden, west						Pat	
Area 9A Pollinator Garden A, west					1	Therese	
Water Barrel Areas							
East end weeding - area 11	1		1				
West end weeding- area 12	1		1				
Barrel maintenance					1	Debbie	
Padlock Keeper					1	Corey	
Water Connection					1	Mark	
Social Coordinators					2		
Garden Inspectors					2		
Tool Keeper					1		
Winter Garden Keeper							1

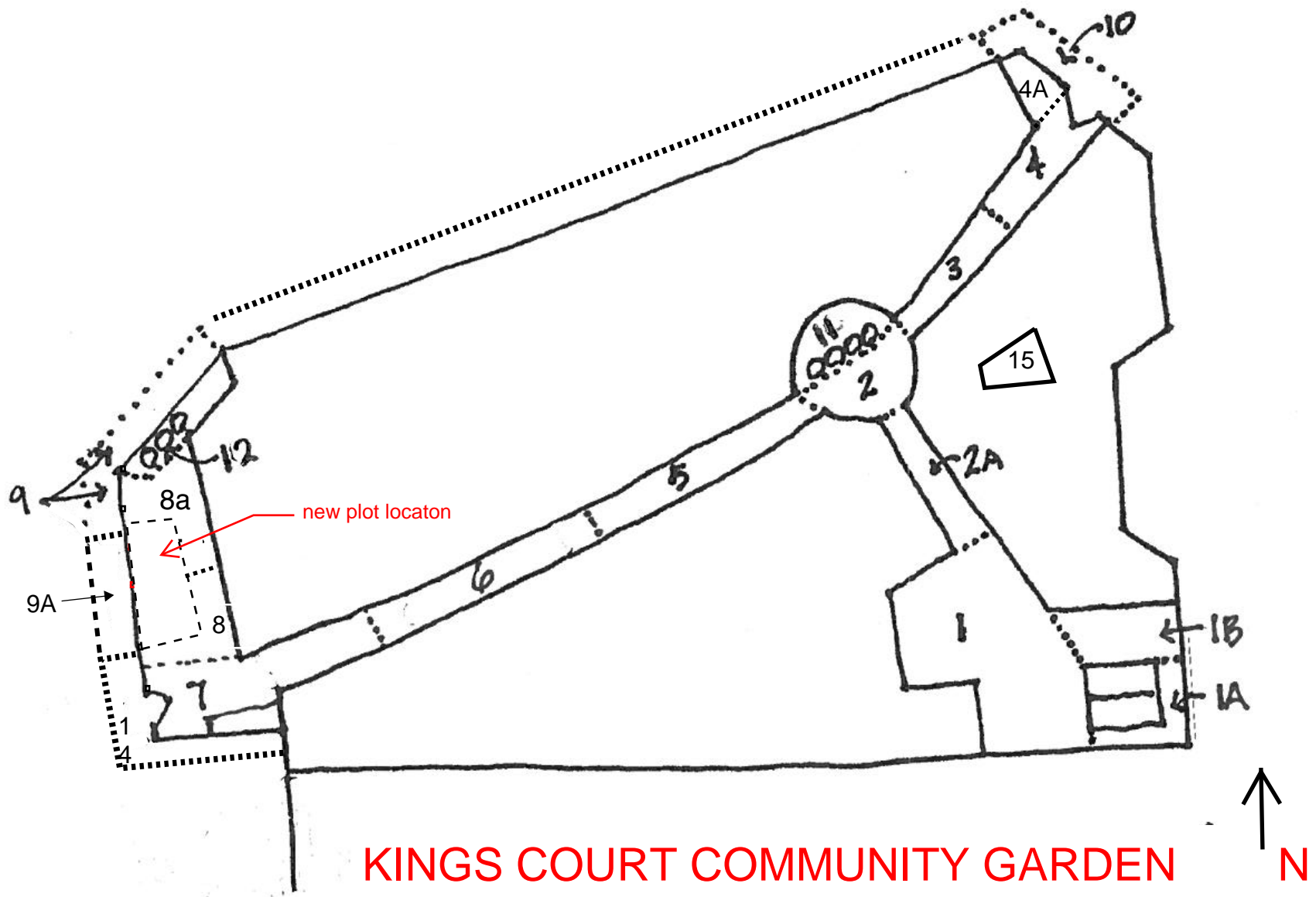

KINGS COURT COMMUNITY GARDEN
2022

KING'S COURT GARDEN COMMUNITY TASKS – 2022

Garden map showing Task Areas is included in this packet

TASK DESCRIPTIONS

Slot: Each work slot fulfills the volunteer requirements for one garden plot. Plot renters with a single plot must sign up for one slot; plot renters with a double plot must sign up for two slots.

Season: A full season is from March through October. The first half season is from March through mid-July, the second from mid-July through October. The winter season is from late October through early March. The start and end of the summer and winter seasons are approximate.

Common Areas (Areas 2, 2a, 3-8, 4a, 8, 8a):

Pathways: Weed and spread chips by May 15, keep area weeded and neat throughout season. Two slots per designated pathway area; one for each half season, see task map. **Task 2** location is the center circle where the water barrels are located. Task 2 is to weed and woodchip this circular area. **Task 2a** is the pathway from center circle to start of East End Meeting Area.

East end Meeting area (Area 1): Keep area mowed, weeded and neat throughout season. Woodchip as needed.

Shed south & east sides (Area 1a) Keep weeded and remove all invasive vines from the fence

Grill area (Area 1B) Keep weeded, inc. invasive vines on fence, neat, & wood-chipped as needed.

East Pollinator Garden (15) Plant, weed, and maintain this numbered section, a triangular area among plots at the east side of the garde.

Water barrel areas (Areas 11 & 12) : Weed and spread chips by May 15, keep area weeded and neat throughout season. Note: Water barrel maintenance will be handled by Debbie Sease.

Exterior Areas:

East Gate Garden: Plant and maintain garden outside the gate, on both sides of the gate.

[Note: gardeners w/plots on alleyway fenceline are responsible for the exterior area outside their fence].

West End Pollinator Gardens on Exterior of Fence (areas 9, 9a) Plant Pollinator Garden Plant, weed, and maintain THIS numbered section, from the West Gate and around the fence corner past the West End water barrels.

Social Coordinator

Inspectors – members of inspection team, which inspects 4 times during the season

Water Chief Teach new gardeners how to use the water hoses and quick-coupling device; make sure hoses and couplings are in work order; coordinate with water supplier.

Padlock Keeper Keeps padlocks in working order; replaces old and non-working padlocks

Winter Garden Keeper: Oversee garden in general between November and March. Perform miscellaneous tasks to keep the Garden in general order. THIS VOLUNTEER must be an active winter gardener.

Community Test Sessions: Participation in a work session. This year we anticipate trimming weed trees in garden boundary areas. Exact time to be confirmed with those who signed up.

In 2022, KCCG Board Members and Gardeners will take the lead in the following major tasks:

Mark Lavens: Water supply chief - In charge of KCCG's hose connection system

Corey Buffo: Padlock Keeper – Keeping the padlocks in working order

Margaret Mook: Coordinator of community tasks – briefing Gardeners on specifics of their chosen tasks, & checking that tasks are being done. Also manager of KCCG's Waiting List. Margaret.mook@gmail.com

TASK SLOTS

Common Area Maintenance

Pathways (areas 2, 2a – 8, 8A, 4A)	20 slots; 10 in early season, 10 in late season
East end meeting space (area 1)	4 slots: 2 early season, 2 late season
Barbeque/grill area (area 1B)	2 slots: 1 early season, 1 late season
Shed sides (area 1A)	2 slots: 1 early season, 1 late season
Shed Interior	2 slots: 1 early season, 1 late season
Mulch & Chip piles	2 slots: 1 early season, 1 late season
East pollinator garden	1 slot for full season

Exterior Area Maintenance

East gate garden (area 10)	1 slot for full season
West end pollinator gardens (9, 9a)	1 slot for full season (Pat Taylor, Therese Slowik)

Water barrels

Water barrel area – east (area 11)	2 slots: 1 early season, 1 late season
Water barrel a43a – west (area 12)	2 slots: 1 early season, 1 late season
Water barrel maintenance	for questions, see Debbie Sease

Community Tasks

Trimming weed trees	2 slots for each specific session.
---------------------	------------------------------------

General

Social Coordinator	1 or 2 slots, for full season
Garden Inspectors	2 slots, each for full season
Padlock Keeper	1 slot for season (Corey Buffo)
Water Connection	1 slot for season (Mark Lavin)
Tool Keeper	1 slot for season
Winter Garden Keeper	1 slot for winter season
